

Important Information

Registration and Information Assistance: The registration desk is located at the main entrance to the Howard Rock Ballroom on the 2nd Floor. In addition to handling all of your conference needs, staff will be on hand to answer any of your questions. The desk will be open from 7am—5pm on Thursday and Friday.

Name Badges: All registered attendees, exhibitors and speakers will receive a name badge. In the interest of security and to make the conference a more enjoyable networking experience for all, we ask that you wear your name badge at all times during the conference. Badges are required for admission to all educational sessions. In the interest of recycling, please drop your name badge into the badge recycle box at the registration desk.

Some delegates will have ribbons attached to their name badges designating them as Conference Planning Committee, Alaska Safety Advisory Council Members, Speakers and/or Exhibitors.

Evaluation Forms: Evaluation Forms for the educational sessions will be distributed during each session and your valuable input helps us to determine future conference speakers. Please complete and return the forms to the session moderator at the conclusion of each session.

Breaks and Refreshments: All refreshments during the breaks will be served in the Trade Show area, this is section A1 of the Howard Rock Ballroom.

Door Prize Tickets: During the conference exciting door prizes will be given away during the morning and afternoon breaks.

Your door prize tickets will be in your registration packet and will be used for all drawings. You need not be present to win, please stop by the registration desk to claim your prizes.

Message and Resume Center: There will be a message board located at the registration desk. You may post messages for other attendees. As a service to attendees, there will be an area near the registration to post resumes and/or for companies to post job openings.

Coat Check: The Amarantha Alaska Court #1 will provide coat check for \$3 per day near the registration desk in the foyer of the Howard Rock Ballroom.

Turn Off Cell Phones: Please remember to keep your cell phones turned off during all speaker sessions.

Smoking/Non Smoking: No smoking is allowed in any area of the Sheraton Anchorage Hotel.

Parking: Parking is available in the surrounding lots for \$8.00 Per day. Please check with the registration desk for any updated information regarding parking.

Used Eyeglasses and Hearing Aids: The Anchorage Area Lions have provided a container, located at the registration desk, for you to recycle used eyeglasses, eyeglass frames and hearing aids.

Welcome and Please Enjoy the Conference!

Schedule at a Glance

| Thursday March 20, 2008 | Track 1 Back to Basics for all- "From School to Retirement" | Track 2 Cold Weather Safety | Track 3 Safety Education | Track 4 Health & Safety -Injury prevention | Track 5 OSHA 10 hour Construction Outreach |
|-------------------------------|--|---|---|---|--|
| 8:00- 8:15 am | Howardrock C | Howardrock B | Kuskokwim East | Kuskokwim West | Yukon |
| 8:15- 8:30 | | Human Factors Richard Caudell | Fall Protection- Fundamentals, OSHA regulations and overview of ANSI Z-359 standard Bob Wujek | The importance of having a substance abuse/ drug testing policy in a workplace Tony Robinson | Introduction to OSHA Rob Wright |
| 8:30- 8:45 | | | | | |
| 8:45- 9:00 | Opening Remarks - Mayor of Anchorage Mark Begich | | | | |
| 9:00- 9:15 | Priority One: Safe Jobs for Alaska's Kids Nathan Menah | Break –Coffee & Snacks in Exhibitors Hall | | | |
| 9:15-9:30 | | | | | |
| 9:30-9:45 | Break | Arctic Survival Richard Caudell | Future of Safety Professionals in Alaska Don G. Weber | Confined Space-the Hidden Dangers Bob Wujek | Fall Protection Bill Nickerson |
| 9:45-10:00 | Youth Employment Occupational Safety and Health Jeff Burton | | | | |
| 10:00-10:15 | | | | | |
| 10:15-10:30 | | | | | |
| 10:30-10:45 | | | | | |
| 10:45-11:00 | | | | | |
| 11:00-11:15 | Break | | | | |
| 11:15-11:30 | Youth Employment Mechanical/Electrical/ Plumbing Essentials Al Nagel | Cold Weather Injury Prevention /Treatment Richard Caudell | Risk Management Fundamentals Steve Millea | Cardiac Risk Factors, AEDs and their use in a Workplace Kathy McLeron | Personal Protective Equipment Rob Wright |
| 11:30-11:45 | | | | | |
| 11:45-12:00pm | | | | | |
| 12:00-12:15 | | | | | |
| 12:15-12:30 | Training Requirements and Opportunities for new employees Don G. Weber | | | | |
| 12:30-12:45 | | | | | |
| 12:45-1:00 | | | | | |
| 1:00-1:15 | | | | | |
| 1:15-1:30 | Violence in the workplace Stephan Hinds | Recreational Safety Doug Van Etten | Risk Management Implementing Your Programs Jared Sherman | Welding Safety TBD | Electrical Mike Schowen |
| 1:30-1:45 | | | | | |
| 1:45-2:00 | | | | | |
| 2:00-2:15 | | | | | |
| 2:15-2:30 | | | | | |
| 2:30-2:45 | | | | | |
| 2:45-3:00 | Corporate Safety Culture How it Effects the Bottom Line Judy Chadwick | Aviation Safety for Alaskan Passengers Craig V. Bledsoe Co-speaker T.C.Wilson | Worker's Compensation Return to Work Programs and The Bottom Line Julie Baecker | 3 D Static Strength Prediction Program John DeCarlo | Tools Rob Wright |
| 3:00-3:15 | | | | | |
| 3:15-3:30 | | | | | |
| 3:30-3:45 | | | | | |
| 3:45-4:00 | | | | | |
| 4:00-4:15 | | | | | |
| 4:15-4:30 | OSHA Updates AK OSH Consultation and Training Staff | Avalanche Safety Terry Onslow | Accident Investigation; A Practical Approach Marie M. Scholle | Posture guidelines for the office Jean Lindberg | Visit Vendors Hall |
| 4:30-4:45 | | | | | |
| 4:45-5:00 pm | | | | | |

| Friday March 21, 2008 | Track 1 Employers Resources | Track 2 Public Safety | Track 3 An Overview of MSHA 30 CFR Part 46 for Sand Gravel and Aggregate Producers Kuskokwim East | Track 4 Health & Safety - Injury Prevention | Track 5 OSHA 10 hour Construction Outreach |
|-----------------------------|--|---|---|--|--|
| 8:00- 8:15 am | Howardrock C | Howardrock B | Kuskokwim East | Kuskokwim West | Yukon |
| 8:15- 8:30 | Workplace Safety Offers Substantial Return of Investment and More Dawn Ring | Personal Safety TBD | History of MSHA and Part 46 Dennis Steffy | Injury Prevention Strategic Planning in Alaska Deborah Hull-Jilly | Materials Handling Ric Gleason |
| 8:30- 8:45 | | | | | |
| 8:45- 9:00 | | | | | |
| 9:00- 9:15 | | | | | |
| 9:15-9:30 | Break –Coffee & Snacks in Exhibitors Hall | | | | |
| 9:30-9:45 | Priority One: Safe Jobs for Alaska's Kids Nathan Menah | Citizens' Awareness of Homeland Security Threats to the State of Alaska BG Tom Westall | Part 46 – The Regulations Dennis Steffy | Home Visit Safety— Tactics and Tips for Human Service Workers in the Field Dan Kantak | Stairs and Ladders Ric Gleason |
| 9:45-10:00 | | | | | |
| 10:00-10:15 | | | | | |
| 10:15-10:30 | | | | | |
| 10:30-10:45 | | | | | |
| 10:45-11:00 | | | | | |
| 11:00-11:15 | | | | | |
| 11:15-11:30 | | | Part 46 –How to get Information Dennis Steffy | Basic Electrical Safety Dawn Ring | Excavations Ed Ness |
| 11:30-11:45 | | | | | |
| 11:45-12:00pm | | | | | |
| 12:00-12:15 | | | | | |
| 12:15-12:30 | | | | | |
| 12:30-12:45 | | | | | |
| 12:45-1:00 | | | | | |
| 1:00-1:15 | | | | | |
| 1:15-1:30 | | | | | |
| 1:30-1:45 | | | | | |
| 1:45-2:00 | | | Training Under Part 46 Dennis Steffy | Be Back- Wise: Taking Care of your Back Jean Lindberg | Scaffolding Jeff Kolean |
| 2:00-2:15 | | | | | |
| 2:15-2:30 | | | | | |
| 2:30-2:45 | | | | | |
| 2:45-3:00 | Developing Worker's Compensation Program Daisy Saffir | An Overview of FAA Safety Team Programs for Passengers and Airmen in Alaska David Karalunas and John Steuernagle | Rights and Responsibilities under the Act Dennis Steffy | Innovative Contractor Techniques to Reduce Injuries while Meeting the Cores' Stringent Safety Requirements Colonel Wilson | Cranes Jeff Kolean |
| 3:00-3:15 | | | | | |
| 3:15-3:30 | | | | | |
| 3:30-3:45 | | | | | |
| 3:45-4:00 | | | | | |
| 4:00-4:15 | | | | | |
| 4:15-4:30 | Developing Tomorrow's Safety Professionals Ric Gleason | Highway Watch Training Seminar Liz Wilson | Safety Inspections, Penalties and Citations Dennis Steffy | Critical Incident Response as a Risk Management Tool Doug Buman | Visit Vendors Hall |
| 4:30-4:45 | | | | | |
| 4:45-5:00 pm | | | | | |

27th Annual Conference

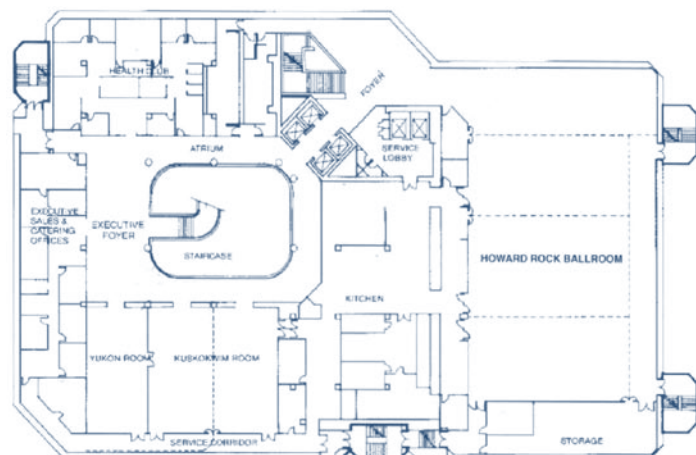

Second Floor

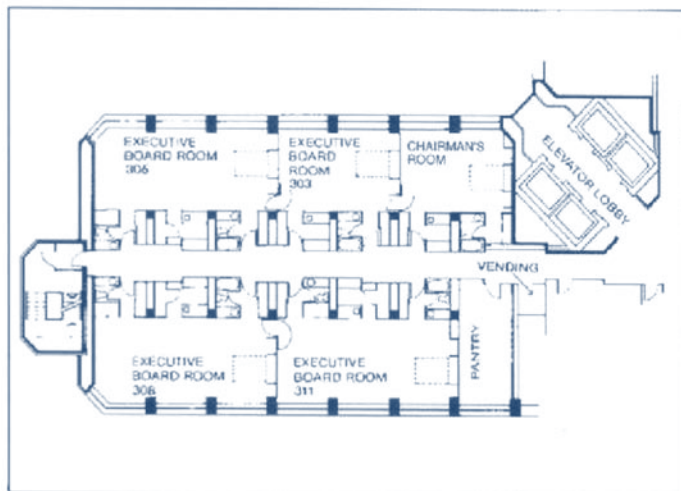

Third Floor

Second & Third Floor Plans

Sheraton Anchorage Hotel • 401 E. 6th Avenue • Anchorage, AK 99501

Phone: 907 276-8700 • Fax: 907 276-7561

"Back to Basics – Safety for Alaskans"



The Office of Governor
SARAH PALIN



March 20, 2008

Greetings!

Welcome to the 27th Annual Alaska Governor's Safety and Health Conference. I am proud to share your interest in making Alaska a safer, healthier place to live and work. By choosing to actively participate, you have accepted the challenge to develop solutions to help avoid workplace and other serious accidents that are so devastating to Alaska's families and businesses.

The training and networking opportunities available at this year's conference illustrate the strong commitment and partnership between industry, government, and labor organizations to focus on safety and health issues that relate to a broad cross section of organizations and individual Alaskans. I hope you take advantage of every resource available at the conference to help ensure that you and your organization are prepared to recognize and overcome the challenges ahead.

We live and work in some of the most hazardous environments in the nation and I am enthusiastic about helping ensure access to every available protection. Taking the time to examine the problems and develop effective and innovative methods to improve results will benefit all Alaskans. Thank you for your participation.

Sincerely,

Sarah Palin
Governor

"Since most Alaskans lead an active lifestyle, we need to keep safety and health foremost in our minds, whether on the job or off. We can never know too much when it comes to the safety and health of our families and coworkers. This conference provides many great opportunities to learn more about safety and health issues and how they affect all aspects of our daily lives."

--Anchorage Mayor Mark Begich



Conference Sponsors

bp



Holland America Line



Alaska

27th
Annual

Celebrating

27

*Years of
Occupational
Safety & Health*